

# Reference projects

## Bridges

---



### Renovation of Le Tirage bridge, Valangin NE

A new bridge to cross the Seyon in Valangin! The new bridge links Rue du Saut to the wooded hillside above Valangin. It can support loads of up to 40 tonnes., Valangin NE

---



### New construction of Wühri Bridge, Horrenbach-Buchen

The new wooden bridge connects the two Bernese villages of Horrenbach-Buchen and Teuffenthal near Thun and replaces an old concrete bridge. The new crossing is capable of carrying loads of up to 32 tons., Horrenbach-Buchen

---



### Wildlife transfer Rynetel, Suhr

It took a long time to convince people: more than 20 years ago, Stefan Zöllig demonstrated that wood is the right choice of construction material for wildlife bridges. Today, the wooden bridge over the A1 highway between Suhr and Hunzenschwil is impressive., Suhr

---



### Wildlife transfer Neuenkirch, Luzern

In Neuenkirch, the Federal Roads Office FEDRO is already building the second wildlife bridge with a wooden overpass after the Rynetel wildlife bridge. The wildlife overpass in the canton of Lucerne has a width of 50 meters and a length of around 36 meters., Luzern

---



### The Tüfisteg pedestrian and bicycle bridge, Adliswil

The Tüfisteg pedestrian and bicycle bridge in Adliswil is getting on in years. Analyses showed that replacing the bridge would cost almost as much as renovating it. Today, a new bridge leads over the Sihl - with beech wood from the surrounding forests., Adliswil

---



### Wooden bridge Sihlmatt, Hirzel

The Sihlmatt wooden bridge has connected the cantons of Zug and Zurich since its construction in 1849-1850. Timbatec Holzbauingenieure AG has determined by means of a condition survey that the bridge urgently needs to be rehabilitated and subsequently supervised the repair project., Hirzel

---



### Access bridge museum, Murten

Forty years after its construction, the pedestrian bridge leading to the Murten Museum was no longer in good condition and needed to be replaced. The new passerelle, designed by Timbatec, is made of durable larch wood from Swiss forests., Murten

---



### **New bicycle and pedestrian bridge over the old Aare river, Lyss**

A new bridge in Lyss should be wider than the old one and passable for bicycles. Nevertheless, it will be supported by the existing abutments., Lyss

---



### **Safe passage to the wilderness park, Horgen-Sihltalstrasse**

Large parts of the Horgen pedestrian bridge over the Sihltalstrasse had to be replaced. Many central wooden elements of the crossing were in poor condition., Horgen-Sihltalstrasse

---



### **Safe passage to the wilderness park, Horgen-Sihltalstrasse**

Large parts of the Horgen pedestrian bridge over the Sihltalstrasse had to be replaced. Many central wooden elements of the crossing were in poor condition., Horgen-Sihltalstrasse

---



### **Renovation Steinbach Bridge, Trubschachen**

The covered wooden bridge at the exit of Trubschachen leads over the Ilfis and provides access to the Steinbach and Buhus area. Although it does not have to carry a great deal of traffic, it does sometimes have to carry quite heavy vehicles., Trubschachen

---



### **Höllbach Bridge, Plasselb**

The bridge connects the districts of Sense and Gruyères and received a certificate for the use of Swiss wood. The new truss structure with shingle roof replaces the old Höllbach bridge, which was destroyed by arson in 2013., Plasselb

---



### **Höllbach Bridge, Plasselb**

The bridge connects the districts of Sense and Gruyères and received a certificate for the use of Swiss wood. The new truss structure with shingle roof replaces the old Höllbach bridge, which was destroyed by arson in 2013., Plasselb

---



### **Connecting bridge Thommen Furler, Rüti bei Büren, Bern**

A pipeline bridge had to be designed for the transport and filling of the chemicals from the storage facilities via the warehouses to the railroad tracks, which would withstand the high demands of the chemicals such as acids and alkalis., Rüti bei Büren, Bern

---



### **Redevelopment - pedestrian bridge, Vechigen**

The pedestrian bridge near Vechigen was built in 1999. From the outside it was in relatively good condition, only the upper covers of the main girders seemed weathered and damaged., Vechigen

---



### **New construction bridge park Gries, Volketswil**

In order to offer the public more recreational and sports opportunities, the political municipality of Volketswil realized an expansion and redesign of this sports and recreational facility., Volketswil

---

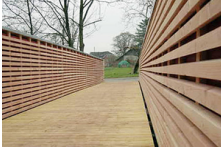

### **New construction of Suhresteg, Buchs AG**

The competition for the replacement of the Suhr bridge was won by the Erne/Timbatec/Moser+Colombo team in the fall of 2005., Buchs AG

---

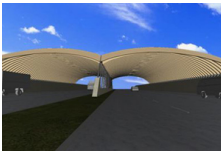

### **Preliminary project wildlife overpasses A1 and T5 / green bridges, Suhr**

The construction of roads and railroad lines has cut up and reduced the existing wildlife habitat. The green bridges serve to reconnect these habitats at important points., Suhr

---



### **New construction Geissegg bridge, Eriz and Horrenbach-Buchen**

The communities of Eriz and Horrenbach/Buchen needed to replace the old, dilapidated concrete trough bridge. The choice quickly fell on wood as a building material., Eriz and Horrenbach-Buchen

---



### **Renovation Rütigrundbrücke, Rüscheegg BE**

On behalf of the Civil Engineering Office of the Canton of Bern, the task was to assess the condition of the Rütigrund Bridge, to prepare a rehabilitation concept and to supervise the rehabilitation on site. Furthermore, the 136-year-old bridge was to be largely preserved and integrated into its surroundings., Rüscheegg BE

---

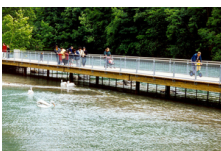

### **Pedestrian footbridge Dählhölzli Zoo, Bern**

The Aare burst its banks in May 1999 in the course of a flood of the century and also caused considerable damage to the zoo., Bern

---



### **Renovation Lower Schwand Bridge, Rüscheegg BE**

On behalf of the Civil Engineering Office of the Canton of Bern, the task was to assess the condition of the Lower Schwand Bridge, to prepare a rehabilitation concept and to supervise the rehabilitation on site. Furthermore, the 133-year-old bridge was to be largely preserved and integrated into its surroundings., Rüscheegg BE

---

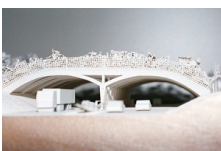

### **Project study green bridge Chüsenrain, Neuenkirch**

Building a green bridge in wood over a four-lane highway is a special challenge. Even though a lot of water will still be flowing down the Reuss until the groundbreaking ceremony, the study that has been prepared shows approaches for a safe and durable solution., Neuenkirch

---



### **Bicycle bridge over the Töss, Wülflingen**

During a flood in the 1960s, the old footbridge at the confluence of the Eulach and the Töss was destroyed. This was not replaced at first. It was not until residents of the adjacent neighborhoods submitted a petition for a new pedestrian footbridge in 1989 that the project planning for a new footbridge was taken in hand., Wülflingen



### **Bicycle bridge over the Töss, Wülflingen**

During a flood in the 1960s, the old footbridge at the confluence of the Eulach and the Töss was destroyed. This was not replaced at first. It was not until residents of the adjacent neighborhoods submitted a petition for a new pedestrian footbridge in 1989 that the project planning for a new footbridge was taken in hand., Wülflingen