

# Conversion Coop City St. Annahof, Zürich

2020

---



The Coop department store St. Annahof on Zurich's Bahnhofstrasse reopened in November 2019 after eight months of renovation. Timbatec inspected the ceiling structures of the upper two floors. In addition, the stairwell was extended.

## The project

The ceiling structures of the upper two floors had to be inspected in a condition analysis. The analysis also included the attic floor including the two valley beam layers. This revealed deficiencies in the area of fire protection. This resulted in a retrofit concept for the use of the warehouse. The stairwells of the two uppermost floors were also closed off. The stairwell sections were encapsulated. During the entire construction period, it was possible to continue shopping on the lower floors.

## The construction

The top floor was reinforced with a strong belt floor. Rock wool panels and gypsum fiberboards were used for the second uppermost floor. The node of the supporting structure, clamps, posts, stirrups, purlins were made fire resistant. CLT panels with encapsulation were used for the staircase.

## The challenge

The Coop City department store is located in the center of the city of Zurich. Logistics were therefore a decisive factor in the choice of construction. All components were dimensioned so that everything could be assembled by hand. For crane hoists, delivery had to take place at night. In addition, the facade lift only had a maximum length of 2 meters.

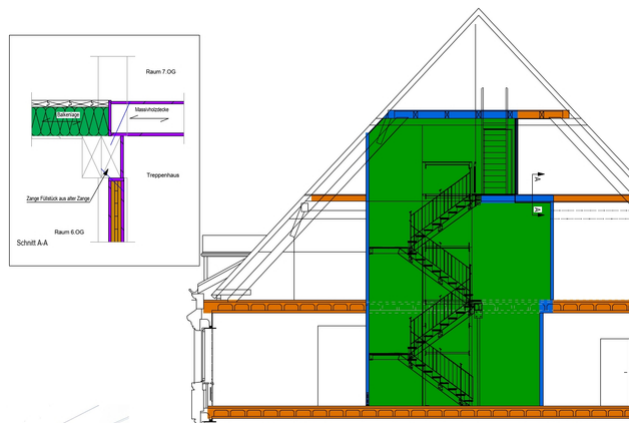

#### Construction Data

- cross laminated timber board 60mm: 100 m<sup>2</sup>
- bottom belt 40mm: 100 m<sup>2</sup>
- Cross laminated timber: 3 m<sup>3</sup>
- construction timber: 3 m<sup>3</sup>
- gypsum fiberboard 18mm: 250 m<sup>2</sup>

#### Construction costs

- BKP 1-9: 1.5 million Swiss francs

#### Services of Timbatec

- SIA Phase 11 Condition analysis
- SIA Phase 32 Construction project
- SIA Phase 41 Tendering and comparison of offers
- SIA Phase 51 Implementation project
- SIA Phase 52 Execution
- SIA Phase 53 Commissioning
- Statics and construction
- Fire protection planning
- cost estimation
- Technical site supervision and site inspections

#### Architect

Dober Bauplanung AG 8196 Wil ZH

#### Client

Coop Genossenschaft 4002 Basel

#### Timberconstruction engineer

Timbatec Holzbauingenieure Schweiz AG 8005 Zurich

#### Timberconstruction

Scherrer Metec AG 8002 Zurich

#### Civil engineer

Dober Bauplanung AG 8196 Wil ZH

#### Construction Management

suisseplan Ingenieure AG 8050 Zurich